

PCB KIT-S

Phase Indicator Panel Kit

IMPACT S Series

The Phase Indicator Panel is designed to provide Line phase indication for L1, L2 and L3 when required in certain applications. It can be used in both 240V ac and 415V ac applications.

The indicator panel is designed to be easily inserted in the new IMPACT S Series - CS and S range of product.

Note: requires a neutral connection.



fig 1.

STEP 1

Ensure power to the applicable circuit is switched OFF.

STEP 2

Remove the screw caps from the cover screws of the S Series product. Remove the screw from the switch cover. (Fig 1)

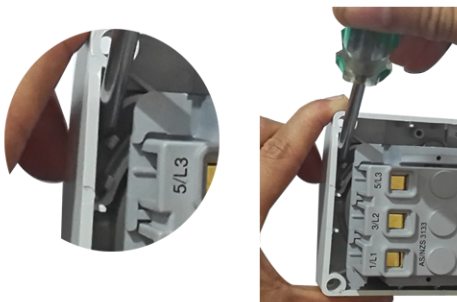

fig 2.

STEP 3

From the rear of the switch, locate the PCB blank panel and retaining clips. Push gently on the 3 blank retaining clips to move the blanking panel forward and out of the switch cover. The blanking panel should simply fall out with ease once the remaining clips are dislodged. (Fig 2)



fig 3.

STEP 4

With the phase indicator panel in one hand, feed the wires through the indicator panel hole in the cover of the switch. (Fig 3)



fig 4.

STEP 5

Ensure the indicator panel is aligned with the shape of the indicator panel hole and gently insert the indicator panel into the housing until the panel clips attach to the housing from the rear. (Fig 4)

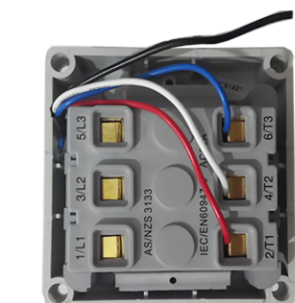

fig 5.

STEP 6

Terminate the wires according to their colour code on the LOAD side of the switch terminals. (Fig 5)

RED - T1

WHITE - T2 (Not required for 240V ac applications)

BLUE - T3 (Not required for 240V ac applications)

BLACK - Neutral

STEP 7

Reattach the switch cover to the mounting base and insert the screw caps.